

COMPRESSORS

HD361C

HD362C

HD363C

HDL362C

HDL363C

HD601B

HD602B

HD603B

HDL602B

HDL603B

Single-Seal

Double-Seal

Triple-Seal

GAS COMPRESSORS

Single-Stage

Non-Lube

**Air or
Liquid-Cooled**

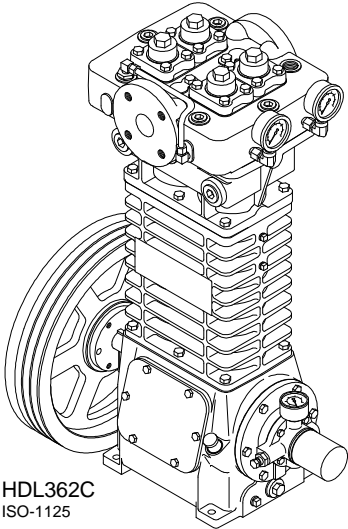

HDL362C
ISO-1125

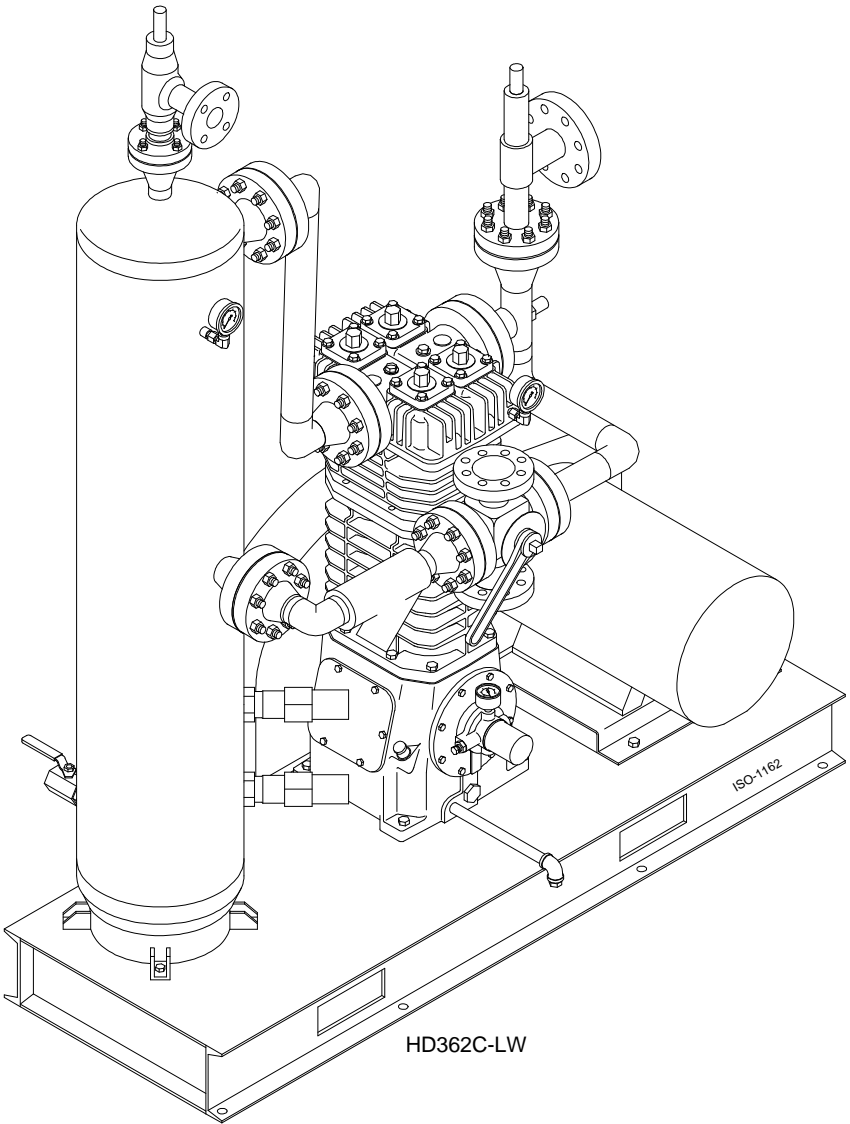

HD362C-LW

SPECIFICATIONS

	Air Cooled HD361C	Water Cooled HDL362C	Air Cooled HD601B	Water Cooled HDL602B
	HD362C	HDL363C	HD602B	HDL603B
	HD363C	HDL363C	HD603B	HDL603B
Number of Cylinders	2		2	
Bore - in. (mm)	4.0 (102)		4.625 (117)	
Stroke - in. (mm)	3.0 (76)		4.0 (102)	
MAWP - psia (kPa)	350 (2,413)		350 (2,413)	
P-rod dia. - in. (mm)	0.75 (19.1)		1.25 (31.8)	
Minimum / Maximum RPM	350 / 825		350 / 825	
Piston Displacement				
@ 100 rpm - CFM (m ³ /hr)	4.36 (7.41)		7.78 (13.2)	
@ Min rpm - CFM (m ³ /hr)	15.3 (26.0)		27.2 (46.3)	
@ Max rpm - CFM (m ³ /hr)	36.0 (61.2)		64.2 (109.0)	
Max. BHP (kw)	15 (11)		40 (30)	
Wt. w/ Flywheel - lb. (kg)	~375 (170)		~705 (320)	
Inlet & Outlet Connections	1.5" ANSI 300#		2" ANSI 300#	

MATERIALS of CONSTRUCTION

Cylinder & Head	Ductile Iron (A536 65-45-12 Nodular)
Pistons	Steel
Piston Rings	Glass & Moly Filled Teflon (Other materials available)
Piston Rods	BSR Steel (Chrome Oxide Coated avail.)
Valve Seats & Stops	Ductile Iron (SS available)
Valve Plates	PEEK (SS available)
Valve Springs	Stainless Steel
Rod Packing	PTFE
Crankshaft	Ductile Iron (A536 80-60-03 Nodular)
Connecting Rods	Ductile Iron (A536 60-40-18 Nodular)
Wrist Pin	Steel
Bearing, Wrist Pin	Steel Needle Bearing (HD360 series) Bronze Sleeve (HD600 series)
Bearings, Rod	Babbitt Lined Steel Backed
Bearings, Crank	Tapered Roller
O-rings	Buna-N (Teflon, Viton, Neoprene, Ethylene Propylene available)
Metal Gaskets	Iron (Copper available)
Other Gaskets	Fiber (non Asbestos)
Crosshead Guide	Ductile Iron (A536 65-45-12 Nodular)
Crankcase	Gray Iron
Crosshead	Gray Iron

FEATURES

Ductile Iron Head & Cylinder provide toughness & strength unmatched by cast iron.

HDL versions feature water-cooled head and cylinders to reduce operating temperatures and extend wear life.

High efficiency PEEK (Poly Ether Ether Ketone) valve plates provide extended life due to the low mass and self-lubricating qualities of the PEEK material. In addition, the slight 'give' of a plastic versus a metal plate allows it to survive more abuse and provide better sealing throughout the life of the valve.

HOERBIGER valves with stainless plates are available for those few applications where PEEK is unsuitable and for those customers that want a HOERBIGER valve.

Extra thick piston rings provide more wear surface to provide greater ring life.

O-ring head gaskets provide positive sealing under all operating conditions. No asbestos to worry about, and materials are available to suit any application.

Triple-Seal (double distance piece), Double-Seal (single distance piece), and Single-Seal (no distance piece) models available.

The center head bolts do not pass through the gas chambers and thus do not require a head bolt gasket. No gasket, no leakage source!

One piece steel pistons are attached to the piston rod via one positive locking nut.

ANSI Flanged Connections allow maximum piping flexibility.

Self-adjusting Teflon piston rod seals provide maximum sealing & minimum friction.

Iron crossheads feature special machined lube channels and porting for maximum lubrication and wear resistance.

Pressure lubricated crankcase via a self reversing oil pump directly driven by the crankshaft. Oil is fed to all bearing surfaces, including the crosshead. In addition an automotive type spin-on oil filter is standard.

OPTIONS

TNT-12 Corrosion & wear resistant treatment.

Various O-Ring materials.

Suction valve unloaders

Extended crankshaft.

Aluminum or Stainless Steel belt guards.

Pressure Switches.

Temperature switches.

Temperature gauges.

Control panels and starters.

Receivers.

Liquid traps.

Capacity control bypass systems.

NPT or welded piping systems.

Inlet filters or strainers.

Alternate piston ring materials.

Hoerbiger valves with SS plates.

Oversized Flywheels

Epoxy paint systems.

Pressure gauges - all types

Vibration switches.

Thermowells.

Relief valves.

Shutoff Valves - Manual or powered

Level switches.

Aftercoolers - air or water-cooled.

Motor or engine drives.

Repair tool kits.

DIMENSIONS

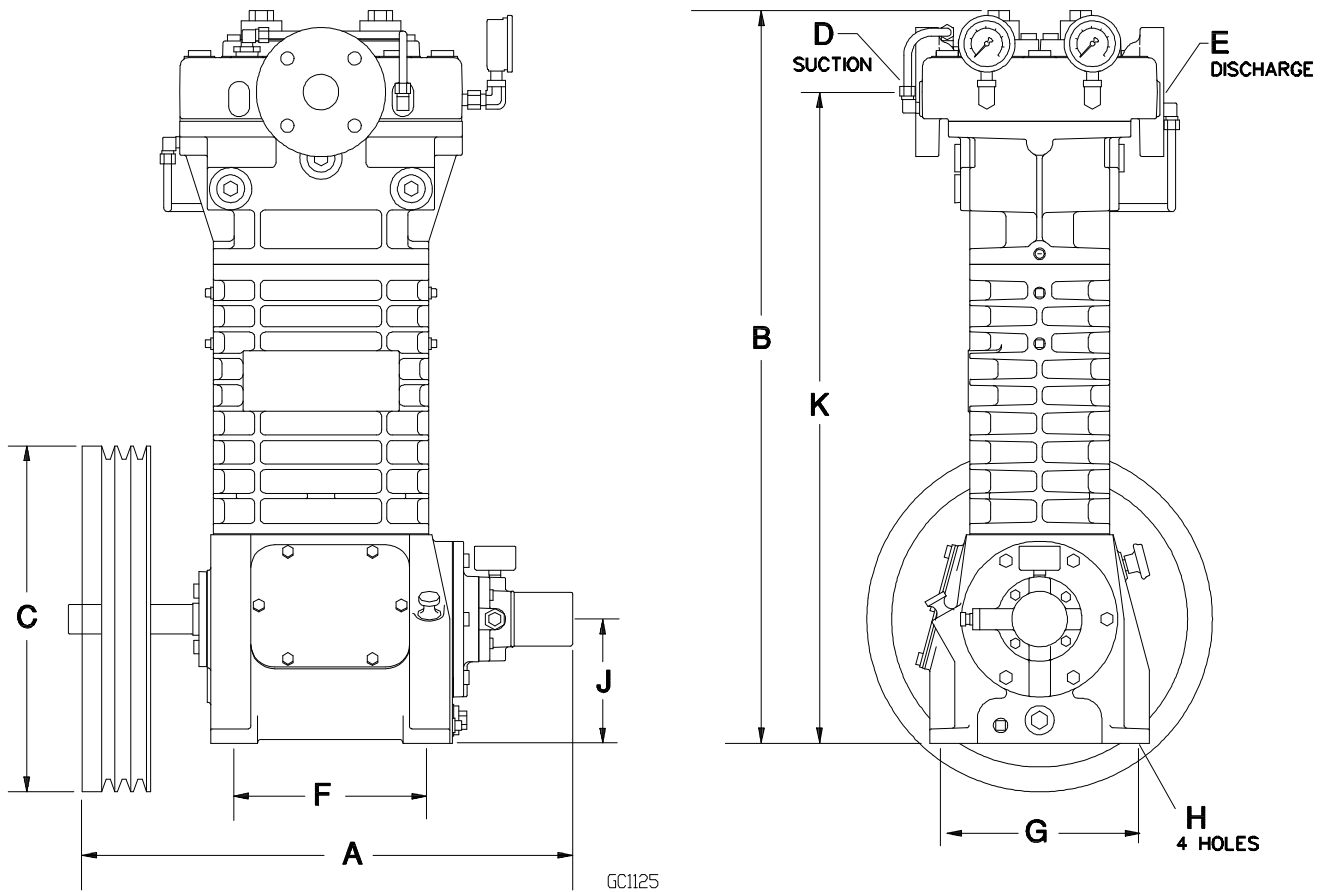

GC1125

In. (mm)

Model	A	B*	C	D	E	F	G	H	J	K
HD361C	23.4 (594)	30.0 (763)	16.35 (415)	1.5" ANSI 300#	1.5" ANSI 300#	9.12 (232)	9.37 (238)	0.5 (12.7)	5.88 (149)	26.13 (663)
HD362C HDL362C	23.4 (594)	34.7 (880)	16.35 (415)			9.12 (232)	9.37 (238)	0.5 (12.7)	5.88 (149)	30.79 (782)
HD363C HDL363C	23.4 (594)	39.3 (998)	16.35 (415)			9.12 (232)	9.37 (238)	0.5 (12.7)	5.88 (149)	35.4 (900)
HDL601B HD602B HDL602B	25.6 (650)	41.0 (1,042)	20.35 (517)	2" ANSI 300#	2" ANSI 300#	10.5 (267)	12.0 (305)	0.56 (14.2)	8.25 (210)	37.0 (940)
HD603B HDL603B	25.6 (650)	47.1 (1,196)	20.35 (517)			10.5 (267)	12.0 (305)	0.56 (14.2)	8.25 (210)	43.1 (1,095)

* For units with Unloaders, add 1.6" (40mm).