

DCV SERIES

**DISC CHECK VALVE**

**1/4" & 3/8" Female NPT**

**0 - 500 Psig**

**Description**

The DCV Series' unique Floating Acetal Copolymer Disc design allows for a positive bubble tight seal with as low as one inch of water crack pressure. Rated for service up to 500Psig, the DCV Series is available with many standard elastomer seal options, making it a versatile choice for many low pressure applications. DCV Series valves can be ordered cleaned for Oxygen service

**Features**

- Ideal for High Cycling Applications
- Quick Acting: less than 10 milliseconds to seal from reversing flow
- No Spring: valve is operated solely by the flow of the media
- Bubble tight closure from virtually zero to 500 Psig

**Technical Data**

Maximum Pressure: 500 Psig

Cracking Pressure: <1" H<sub>2</sub>O

Flow Coefficient Cv:

1/4" - 0.80

3/8" - 1.35

Temperature Rating: -40°F to 210°F (-40°C to 100°C)

*(based on seal selection, see ordering information)*



**Materials of Construction**

Component	Valve Body Material
Body, End Cap	Brass, ASTM B16
Poppet Disc	Acetal Copolymer, Delrin
O'Ring	Viton™

# SERIES DCV DISC CHECK VALVE

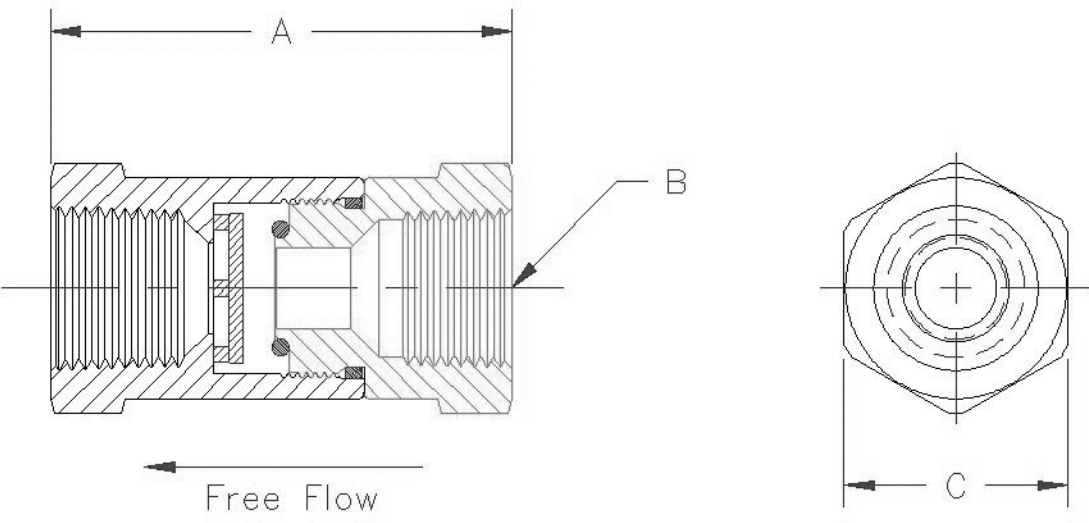

**Dimensions**

Model Code	A	B	C
DCV - 250B	1 - 15/16"	1/4" NPT	3/4"
DCV - 375B	1 - 15/16"	3/8" NPT	15/16"

**Ordering Information**

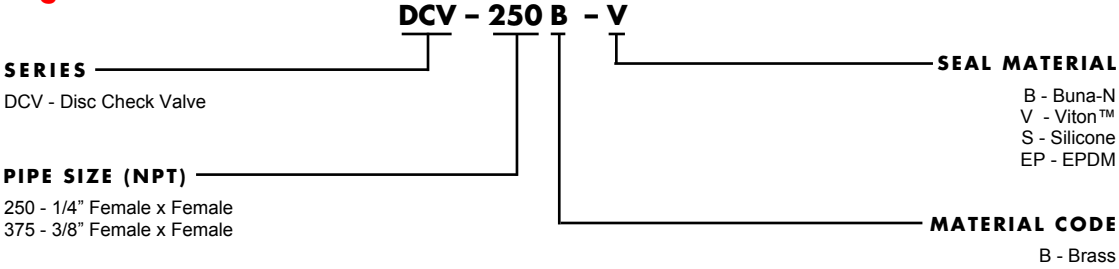

PROPER COMPONENT SELECTION - When specifying a component, the total system design must be considered to ensure safe and trouble-free performance. Intended component function, materials compatibility, pressure ratings, installation, environment and maintenance are the responsibility of the system designer.



[www.generant.com](http://www.generant.com)

Version 07.08.02