

# Check Valves

## C-Series

Especially designed for the control of hydraulic and pneumatic systems. Allows full-flow in one direction only.

### Features:

- Efficient in line design provides high flow capability with low pressure drop.
- Soft seat poppet (available on 1/4 and 3/8" models) assures leak free service. Durable all metal poppets standard on all other models.
- Steel valves are zinc plated with "golden glow" chromate for double corrosion protection.
- Versatile design can be mounted in any position.

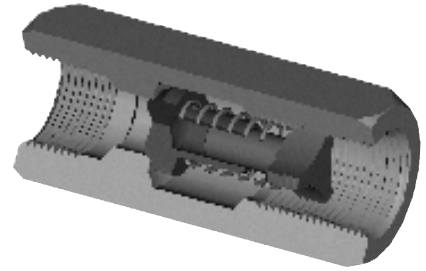

### Ordering Information:

Part Number	Body Material	P (NPT) Female	D (In.) Hex	L (In.)	Orifice Diameter	CV	Piston Seal	Maximum Operating Pressure (PSI)
C250B	Brass	1/4	1 1/16	2 3/8	.297	.87	Metal	2000
C250BL							Viton	250
C375B		3/8	1	2 1/2	.390	2.25	Metal	2000
C375BL							Viton	250
C500B		1/2	1 1/8	3	.406	3.46	Metal	2000
C500BL							Viton	250
C750B		3/4	1 1/2	3 5/8	.625	5.20	Metal	2000
C750BL							Viton	250
C250S	Steel	1/4	1 1/16	2 3/8	.297	.87	Metal	5000
C375S								
C500S		1/2	1 1/8	3	.406	3.46		
C750S								
C250SS		Stainless Steel	1/4	1 1/16	2 3/8	.297		
C250SSL	Viton						250	
C375SS	3/8		1	2 1/2	.390	2.25	Metal	5000

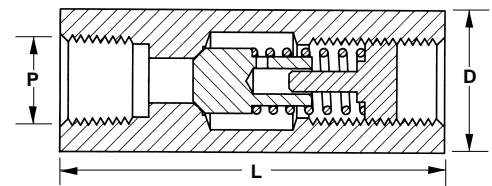

Metal to Metal Seat

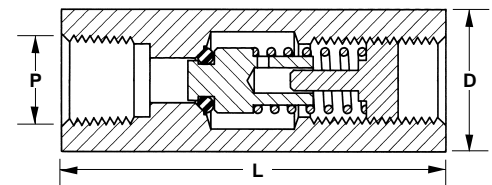

Soft Seat

### Specifications:

Maximum Operating Pressure	See Ordering Information
Temperature Range	-20°F to +212°F
CV Factor	See Ordering Information
Cracking Pressure	5 PSIG Standard, call for other settings

### Materials:

Body	ASTM B 16 Brass, 12L14 Steel, or 303 Stainless Steel
Spring	Stainless Steel
Piston	Stainless Steel
Piston Seal	See Ordering Information

### Performance

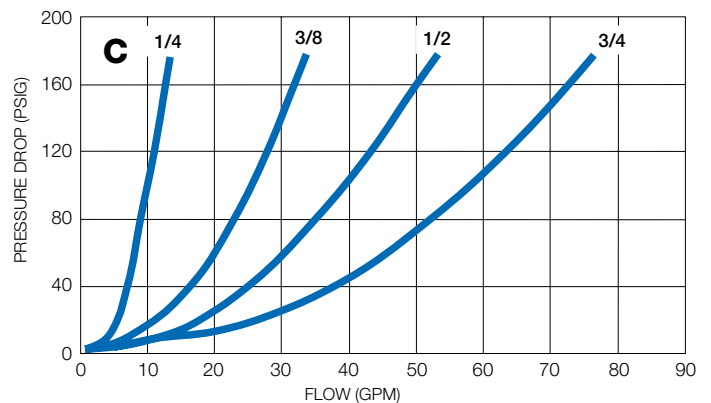

# Check Valves

## BC & PC Series

Compact, versatile design for the control of air and liquids.  
Allows full-flow in one direction.

### Features:

- Piston check design for leak-free air service.
- Ball check design for heavy duty liquid service.
- Low cracking pressures and smooth operation provide efficient service.
- Steel valves are zinc-plated and sealed with “golden glow” chromate for double corrosion protection.

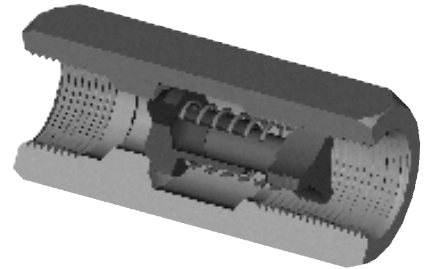

### Ordering Information:

Part Number	Body Material	Check Style	P (NPT) Female	D (In.) Hex	L (In.)	G (In.)	Orifice Diameter (In.)	CV	Cracking Pressure (PSIG)	
PC125B	Brass	Piston	1/8	1 1/16	1 1/2	9/32	.203	.21	10	
PC250B			1/4	7/8	2	5/16		.45	7	
PC375B			3/8	1 1/16	2 1/4	1 1/32		.272	1.00	8
PC500B			1/2	1 5/16	2 2 1/32	3/8		.328	1.60	1/2
BC125B	Brass	Ball	1/8	1 1/16	1 1/2	9/32	.203	.21	11	
BC250B			1/4	7/8	2	5/16		.45	7	
BC375B			3/8	1 1/16	2 1/4	1 1/32		.272	1.00	3
BC500B			1/2	1 5/16	2 2 1/32	3/8		.328	1.60	1
BC250S	Steel	Ball	1/4	7/8	2	5/16	.203	.45	7	
BC375S			3/8	1 1/16	2 1/4	1 1/32		.272	1.00	3
BC500S			1/2	1 5/16	2 2 1/32	3/8		.328	1.60	1
BC750S			3/4	1 5/8	3	15/32		.453	2.21	3

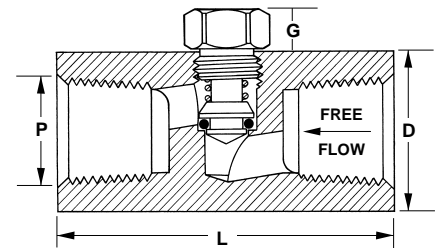
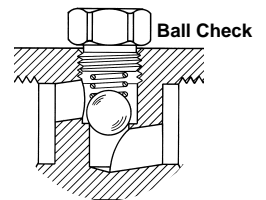

### Specifications:

Maximum Operating Pressure	
“BC” Models	5000 PSIG Steel 2000 PSIG Brass
“PC” Models	2500 PSIG Steel 2000 PSIG Brass
Temperature Range	-20°F to +212°F
CV Factor	See Ordering Information

### Materials:

Body	12L14 Steel or ASTM B16 Brass
Piston Assembly “PC” Models	Stainless Steel with O-Ring
Ball, “BC” Models	Stainless Steel
Spring	Stainless Steel
Plug	Steel or Brass

### Performance

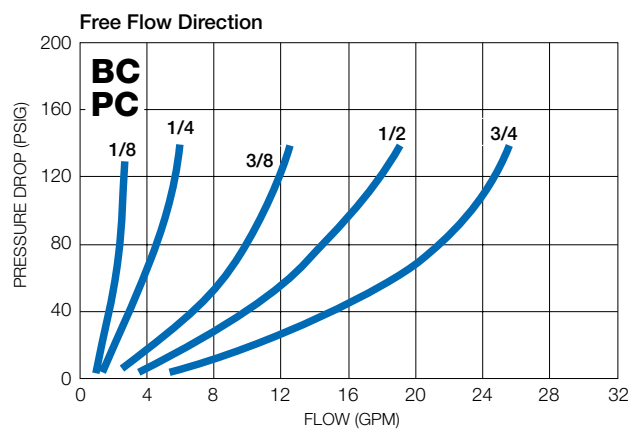

# Check Valves

## CMM Series

Space saving, in-line design for the control of air and liquids.

### Features:

- Metal to Metal seal for leak-free liquid service.
- O-ring design for leak-free air service.
- Steel valves are zinc-plated and sealed with clear chromate for double corrosion protection.

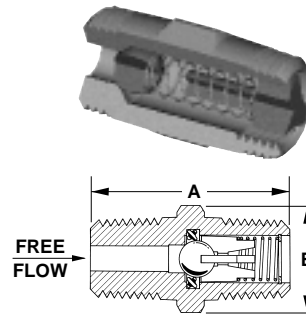

### Specifications:

Maximum Operating Pressure	See Ordering Information
Temperature Range	-20°F to +400°F
Cracking Pressure	See Ordering Information
CV Factor	See Ordering Information

### Materials:

Body	ASTM B 16 Brass or 12L14 Steel
Ball	Stainless Steel
Retainer	Brass or Steel
Spring	Stainless Steel

### Ordering Information:

Part Number	Body Material	Seal	Port Size (NPT) Male	A (In.)	B (In.) Hex	Orifice Diameter (In.)	CV	Cracking Pressure (PSIG)	Maximum Pressure (PSIG)
CMM250B	Brass	Metal	1/4	1 5/32	9/16	3/16	.5	7	1000
CMM250B-L		Viton							
CMM375B		Metal	3/8	1 9/8	1 1/16	1/4	.8	3	
CMM250S	Steel	Metal	1/4	1 5/32	9/16	3/16	.5	7	3000
CMM250S-L		Viton							
CMM375S		Metal	3/8	1 9/8	1 1/16	1/4	.8	3	

## 8830E Excess Flow Check Series

Designed to automatically close when air flow exceeds a safe level. For use on all compressed air hoses leading to air tools and pneumatic components.

### Features:

- Re-sets automatically.
- In-line design for easy installation.

### Operation:

During normal operation, a specially molded seal (A) is held away from its seat (B) by spring (C). Air flow is allowed to pass through the orifice (D). When a sudden surge of air flow occurs which exceeds the rated flow of the valve, the resulting pressure differential forces the spring to compress and the seal to contact its seat as in figure 2. After the cause of the higher air flow is repaired, air passing through orifice (E) slowly builds downstream pressure until the differential is low enough for the spring to return the seal to its normal position.

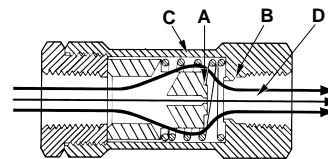
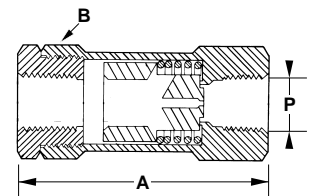
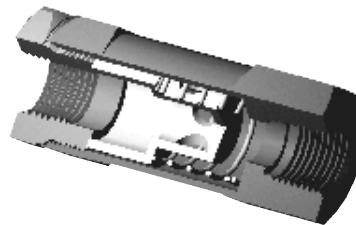

fig. 1 Normal flow condition

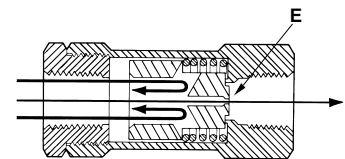

fig. 2 Shut-off condition

### Specifications:

Maximum Operating Pressure	250 PSIG Air
Temperature Range	-40°F to +250°F

### Materials:

Body	Aluminum
Seat	Delrin
Spring	Stainless Steel

### Ordering Information:

Part Number	P (NPT) Female	A (In.)	B (In.) Hex	Approximate closing flow rate (Standard cubic feet per minute/air)						
				(Inlet Pressure PSIG)						
				25	50	90	125	150	200	250
8830E3	3/8	3 1/2	1 3/8	29	38	48	56	60	69	76
8830E4	1/2			50	65	80	90	100	115	125
8830E6	3/4	5	2 1/4	140	175	200	260	280	320	360
8830E8	1			210	265	340	395	425	490	540